



Diaphragm-Type Diaphragm Seal

All Welded Diaphragm Threaded Diaphragm Seal

Type L990.34

Diaphragm Seals

Application

Process industry diaphragm seal to combine with Bourdon tube pressure gauges. Intended for corrosive, contaminated, hot or viscous pressure media.

Design

Upper and lower housing welded with Internal welded diaphragm, threaded process connection; requires hydraulic fluid to transmit pressure to instrument

Process Connection

1/4" NPT to 1" NPT

Instrument Connection

Capillary, 1/4" or 1/2" NPT-female

Suitable Pressure Ranges

2 1/2" Gauge: 100PSI to 9000PSI

4 and 4 1/2" Gauge: 400PSI to 9000PSI

Available Options (connections, materials, flushing ports, etc.)

See Selection Guide (over)

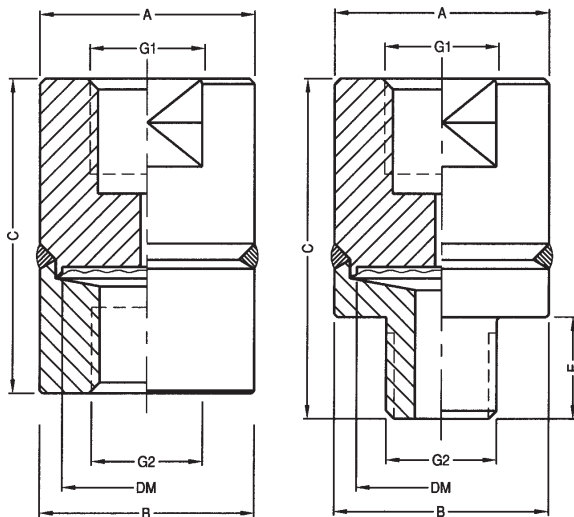

G1: INSTRUMENT CONNECTION
 G2: PROCESS CONNECTION
 DM: EFFECTIVE DIAPHRAGM DIAMETER
 ALL DIMENSIONS IN INCHES UNLESS OTHERWISE NOTED

G1	G2	A	B	C	DM	E	WEIGHT
							lbs.
1/4"NPT OR 1/2"NPT	1/2"NPT MALE	1.60	1.56	2.50	1.3	0.75	0.77
	1/4"NPT OR 1/2"NPT FEMALE		1.60	2.32		N/A	0.77

DWG.#2212170-5

To determine the effects of temperature and response time in a specific application, contact the factory for an **Application Questionnaire**. The information provided will allow WIKA Technical Support to accurately model your application parameters using state-of-the-art computer simulation techniques.

ACS L990.34
 (ACS 99.12)

Selection Guide - L990.34

L990.34,1/4X1/4F-0,SS,SS,SS

Diaphragm Material

SS = 316 stainless steel

MO = Monel® 400 (See note 2)

HC = Hastelloy® C-276

Lower Housing Material

SS = 316 stainless steel

MO = Monel® 400 (See note 2)

HC = Hastelloy® C-276

Upper Housing Material

SS = 316 stainless steel

MO = Monel® 400 (See note 2)

HC = Hastelloy® C-276

Flushing Connection (See note 1)

0 = None

1 = 1/8" NPT female

2 = 1/4" NPT female

Process Connection

1/4F = 1/4" NPT female

1/2F = 1/2" NPT female

1/4M = 1/4" NPT male

1/2M = 1/2" NPT male

3/4M = 3/4" NPT male

1.0M = 1" NPT male

Instrument Connection

1/4 = 1/4" NPT female

1/2 = 1/2" NPT female

CPL = Capillary connection (To weld capillary directly to seal)

Diaphragm Seal Design (Pressure rating – 9,000PSI)

L990.34 = All Welded Design

Notes

1. Customer to supply flushing plug.
2. Upper housing, diaphragm and lower housing must be the same material.

*Items in **bold** are available from stock (subject to prior sales). For optional items, consult factory for current lead-time.*

Options not listed may be available, please consult factory.

Fill Fluid & Mounting options: Please reference data sheet ACS 99.MO

THE MEASURE OF Total Performance™

Ordering Information:

State computer part number (if available) / type number / size / range / connection size and location / options required.

Specifications given in this price list represent the state of engineering at the time of printing. Modifications may take place and the specified materials may change without prior notice

05/01



WIKAI Instrument Corporation

1000 Wiegand Boulevard

Lawrenceville, Georgia 30043-5868

Tel: 770-513-8200 Fax: 770-338-5118

http://www.wika.com e-mail: chemseal@wika.com